

# Water Leak Probe WLC-02

The WLC-02 water leak probe can use by connecting to the WL (Water Leak) port on the data collection terminal (DCT200).

## Technical Specifications

Temperature Range	0 / +60 °C
Humidity Range	%0 - %90 (Non-Ceoncensing)
Product Warranty	2 Years
Protection Class	IP 65
Compability	TS EN 61000-6-2
Dimensions	80 x 65 x 28 mm

# Water Leak Probe WLC-02

## Sensor Connection

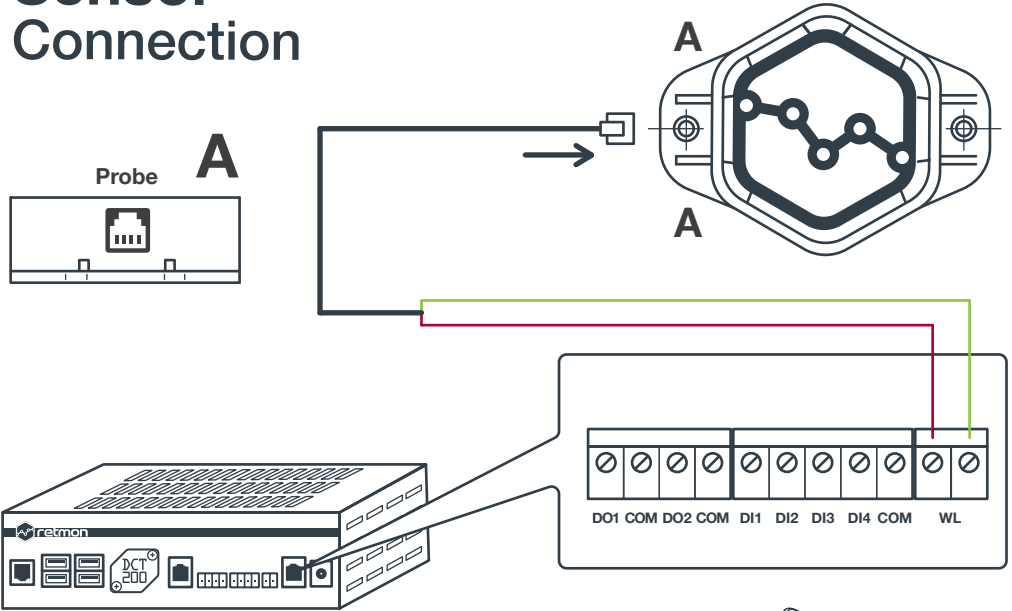

## WLC-02 Probe Mount

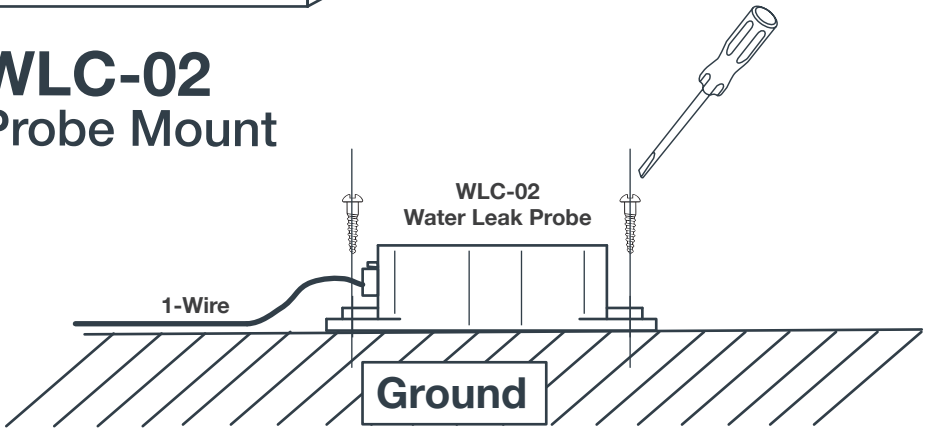

It is important to install the water leak sensor probe where water leakage may occur. For example: In data centers, server rooms can be installed on the floor below. The place to be installed must be free from dust.